

RM 128 media

← 26 ft →



Screen here

door

↑ 28 ft ↓

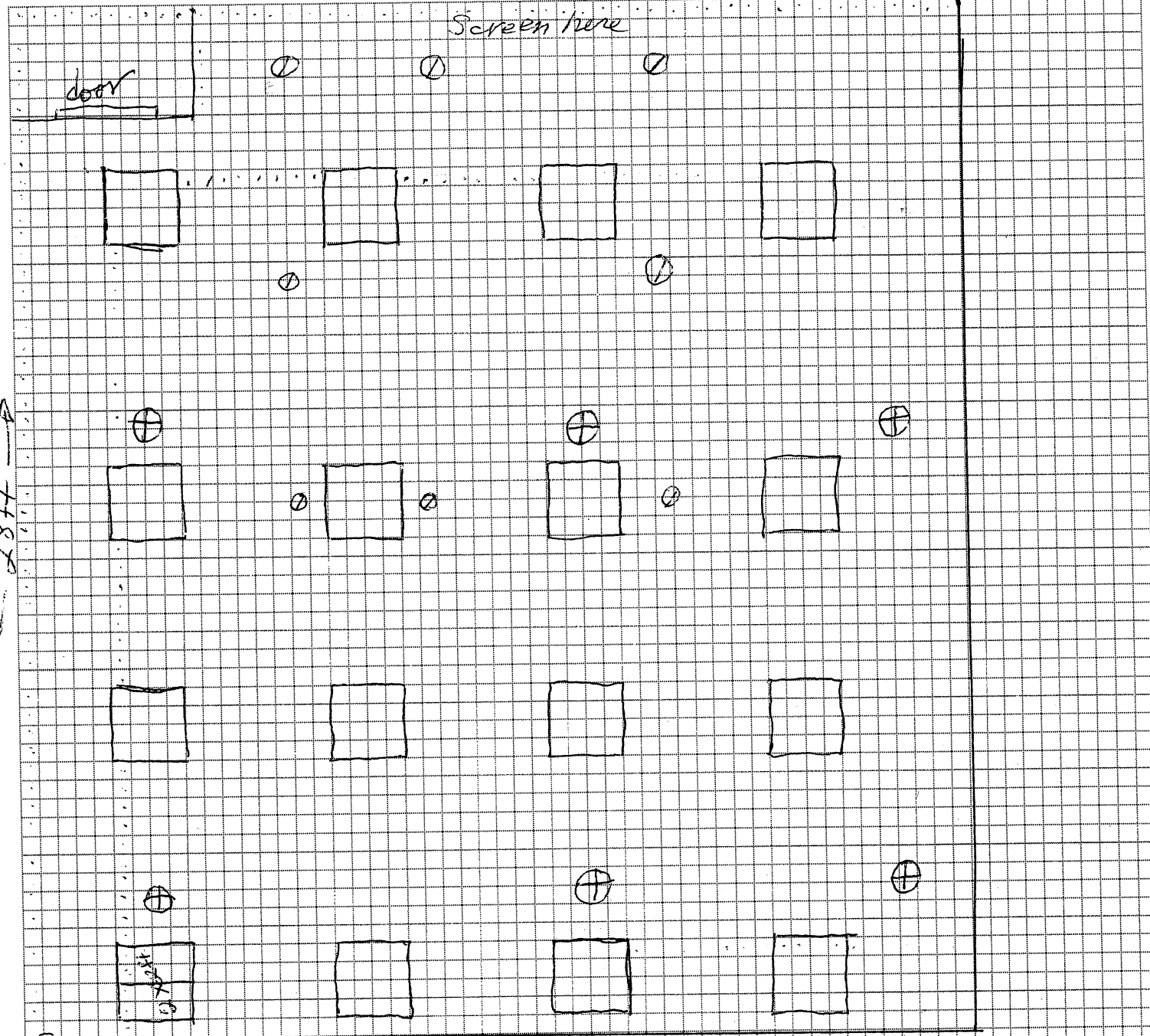

- ① Rooms existing cable hung 5 - 2 bulb T8 - 35K fixtures connected inline first row.
- ② second row existing cable hung 3 - 2 bulb T8 - 35K fixtures connected inline.
- ③ third row existing cable hung 6 - 2 bulb T8 - 35K fixtures connected inline. drop ceiling existing making 2x2ft LED troughs needed with 0-10V dimmer switches 3 way wired.
- ⊕ existing 6 - 6" round recessed 75W PAR30 120V on two separate dimmers
- ⊙ existing 8 - 50W 120V Quartz halogen bulbs on separate dimmer control  
6-10 base ⊙